

# Product Catalog

Polycarbonate 2024 Version

Dome

All prices can be found at  
[www.dreamdomes.no](http://www.dreamdomes.no)



# CONTENTS

01. Brand Story .....	Page 3
02. About us .....	Page 4
03. Product Introduction .....	Page 5
04. Our Advantages .....	Page 6
05. Product Advantages .....	Page 7
06. New models 2024.. .....	Page 8
07. Product Series	
Starry Sky Series .....	Page 9-25
Starry Sky Pro Series .....	Page 26-27
Star Capsule Series .....	Page 28-35
Stargate Series .....	Page 36-39
Stargate-L Series .....	Page 40-41
Gondola Series .....	Page 42-45
Aurora Series .....	Page 46-49
08. Product Applications .....	Page 50-51
09. Customized Products and Projects .....	Page 52
10. Contact Us .....	Page 53

# Brand Story + + +

The development of architectural space has evolved from cave dwellings, nest dwellings, wooden buildings, modern cement brick walls, to various industrial prefabricated houses. People have gained more and more rich experiences and the convenience of technology. However, in the process of growth and spread of traditional buildings, it is full of alienation and destruction of nature. Is there a kind of architectural space that can be perfectly integrated into various environments, close to nature, and coexist harmoniously? Based on this problem, **Dreamdomes** is the first in the world to launch the concept of 360° fully transparent starry-sky dome house. Taking outdoor cultural tourism accommodation as the market entry point, it provides a brand-new sojourn that is different from traditional styles such as PVC tents, wooden houses, and RVs. solution.

“Live in the scenery and let nature be the guest bedroom”. 100% transparent design, 360° viewing experience without dead ends. Users can feel the surrounding mountains, rivers, lakes, seas, and vast stars without leaving home.

As a leader in the outdoor transparent living industry, we rely on years of material research and design and processing advantages to continuously upgrade and optimize the living experience, aiming to provide an outdoor lifestyle that lives in harmony with nature and poetic living.



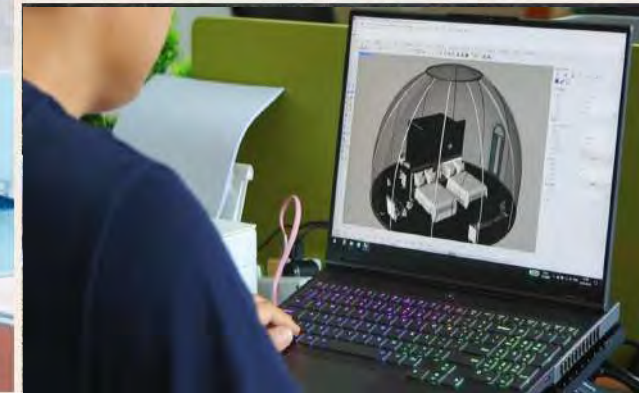

## About US + + +

**Dreamdomes** is a manufacturing and industrial company from Guangzhou city, China, specializing in the design, production and sales of transparent PC Starry-Sky Domes. We currently has a team of more than 60 people, including landscape planning, industrial design, structural design, mold design and other design and development personnel.

The factory's workshop area is about 10,000 square meters, with various advanced integrated thermoforming equipment, CNC five-axis engraving machine, Constant temperature and humidity equipment, aluminum bending and finishing and other equipment. After years of precipitation and development, the company has become a comprehensive service provider of transparent PC domes products in the global market!

**We are the only factory that can produce the D10M Clear PC Domes with two floors!**

# Product Introduction + + +

**Dreamdomes** series is a brand-new characteristic dome house product that we have created. The product structure does not contain a metal supporting frame and has a 360-degree transparent view.

The main material of the product adopts imported polycarbonate (basic material of bullet-proof glass and explosion-proof shield) and aviation aluminum profile, which has high safety and strong protection. It can safely avoid snakes, insects, ants, and large beasts in the wild.

At the same time, the product adopts modular assembly design, the installation and disassembly process is simple and fast, and the on-site assembly cost is low.

Dreamdomes series products have a variety of specifications such as diameters of 2.1M, 3.5M, 4M, 4.5M, 10M, lengths of 5.0M, 6.5M, 7.0M, 8.5M, and products of different specifications can be spliced and combined with each other. The product is highly flexible and can meet the application needs of multiple scenarios.



# Our Advantages +++



## Experience in Over 1000 Projects

We are the first manufacturer in China to develop Clear PC Domes. We have served more than 1,000 customers worldwide, and have rich experience in the implementation of large projects. The projects have been implemented in China: 200pcs of Five Stars Dome House in Alxa , 72 sets of 5.0+2.1M PC Domes in Chaka Salt Lake, 24 sets of 5.3+2.1M PC Domes in Aha Prefecture, 60pcs of 3.0M PC Domes in Wugong Mountain, etc.

## More Than 10 Design Teams

With a mature technical appearance and landscape planning and design team, we can provide customers with overall planning, market positioning and other services in the early stage of the project. In the middle of the project, we can provide customers with indoor decoration supporting reference to assist customers in the implementation of the overall project. Customized product design services can be also provided.

## 15 Years of Manufacturing & Processing Experience!

We have 15 years of experience in processing and manufacturing, and are one of the first batch of manufacturers engaged in PC blister thermoforming in the industry. We have the largest fully automatic blister equipment in China, and many years of processing and manufacturing experience to ensure the high quality of the finished products of PC Domes

## International Team. Quality Service to the World!

We have an international service team, and the core personnels have 10 years of foreign trade experience. The products have been exported to the United States, Canada, France, Norway, Australia, Turkey, Japan and other countries, and got highly praise among the customers!

# Product Advantages ++++

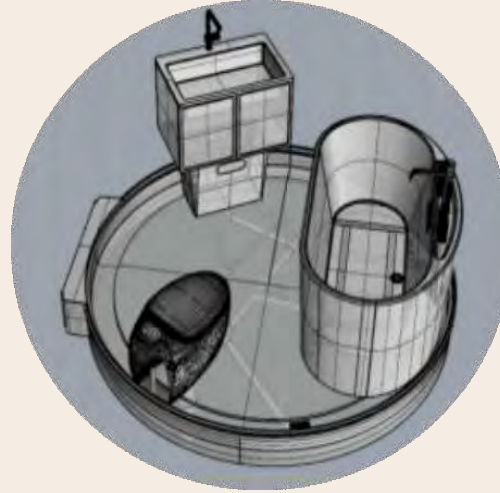

## Detachable, Movable, High Flexibility!

The Clear PC Dome belongs to a transparent movable tent, which does not occupy construction land and does not require construction indicators. The installation is easy and fast with the excellent structure design. It can be built in some alpine areas where there cranes can not reach!

## Selected Materials, Exquisite Workmanship

The transparent part is made of polycarbonate material imported from Bayer, Germany, with double-sided UV coating, strong weather resistance and long service life.

The aluminum part is made of aviation aluminum, integrated drawing and bending process. The doors and windows are double-sealed, suitable for outdoor applications. It's wind/water/sand/mosquito-proof!

## Perfect Detail Design

Perfect bathroom solution with an integrated SMC bathroom floor. There is no need to lay floor tiles, overall waterproof and easy construction.

The outer RGB LED Strip Light adopts aluminum backplane with the overall snap splicing method, it's easy to install and maintain.

The aluminum alloy base comes with special weak current Wire trough, hidden wires, simple and beautiful.

## Multiple Thermal Insulation Solutions

It can be upgraded with a infrared resistance PC material, the temperature difference is 5° C lower than that of ordinary imported PC material.

The whole dome is equipped with an air-in and out-air exchange system to actively circulate the indoor air, and the new patented sunshade canopy is also optional.

# New models 2024

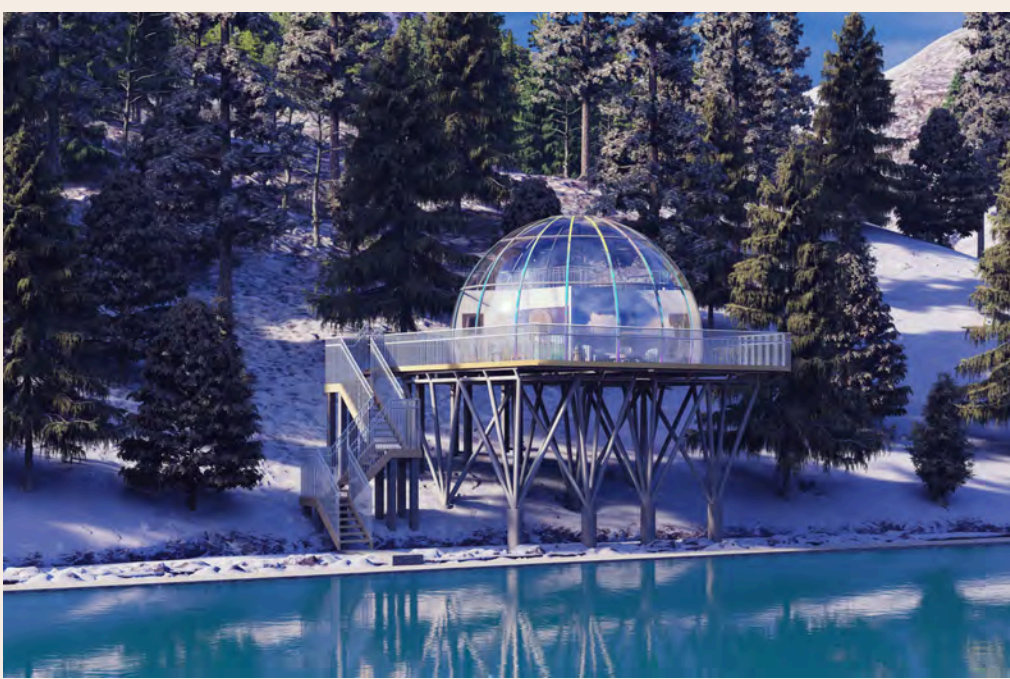



# Starry Sky Series Polycarbonate Domes



# Dreamdomes 2.2 - Mini Ver.



## Basic Parameters

Size: $\phi 2.25M * H1.68M$	Area: 3.5m <sup>2</sup>
Proposal Application: Camping (2 People)	N.W.: 120Kg
Main Material: PC + Alu.	Service Life: >25 Years

## Basic Configurations

Main PC Dome: 1 Set	Alu. Alloy Door with Screen Window: 1 Set
Electronic Door Lock: 1 Set	Exhaust Fan: 1 Set
Waterproof Mat: 1 Set	Installation Kits: 1 Set

## Optional Configurations

- \* Curtain System - High quality sunshade curtain with all necessary kits
- \* RGB LED Light - Alu. heatsink + SMD5050 RGB LEDs + Milky PC Cover
- \* High Quality Mattress - 1 Set

**Polycarbonate (PC):** Imported from Bayer, Germany. With double-sided 100 $\mu$  UV coating, 100% UV resistance.

**Aluminum Alloy Base:** 6063-T5 aluminum alloy with anodizing treatment as well as powder coating, it's anti-corrosion.

# Dreamdomes 3.0A



## Basic Parameters

Size: $\phi 3.0M * H2.55M$	Area: 7.45m <sup>2</sup>
Proposal Application: Camping / Restaurant	N.W.: 200Kg
Main Material: PC + Alu.	Service Life: >25 Years

## Basic Configurations

Main PC Dome: 1 Set	Alu. Alloy Base: 1 Set
Alu. Door with Mechanical Lock: 1 Set	Alu. Window: 2 Sets
Top Alu. Alloy Connecting Ring: 1 Set	Installation Kits: 1 Set

## Optional Configurations

* Curtain System - Manual or electric version optional	
* RGB LED Lighting	* Base LED Lighting
* Exhaust Fan	* Window Screen for the Door
* Window Screen for the Window	* Electronic Lock
* D2.1M Bathroom Dome	* Infrared Resistance PC Body

**Polycarbonate (PC):** Imported from Bayer, Germany. With double-sided 100 $\mu$  UV coating, 100% UV resistance.

**Aluminum Alloy Base:** 6063-T5 aluminum alloy with anodizing treatment as well as powder coating, it's anti-corrosion.

# Dreamdomes 3.5A



## Basic Parameters

Size: $\phi 3.48\text{M} \times \text{H}2.7\text{M}$	Area: $9.2\text{m}^2$
Proposal Application: Camping / Restaurant	N.W.: 220Kg
Main Material: PC + Alu.	Service Life: >25 Years

## Basic Configurations

Main PC Dome: 1 Set	Alu. Alloy Base: 1 Set
Alu. Door with Mechanical Lock: 1 Set	Alu. Window: 2 Sets
Top Alu. Alloy Connecting Ring: 1 Set	Installation Kits: 1 Set

## Optional Configurations

* Curtain System - Manual or electric version optional	
* RGB LED Lighting	* Base LED Lighting
* Exhaust Fan	* Window Screen for the Door
* Window Screen for the Window	* Electronic Lock
* D2.1M Bathroom Dome	* Infrared Resistance PC Body

**Polycarbonate (PC):** Imported from Bayer, Germany. With double-sided  $100\mu$  UV coating, 100% UV resistance.

**Aluminum Alloy Base:** 6063-T5 aluminum alloy with anodizing treatment as well as powder coating, it's anti-corrosion.

# Dreamdomes 4.0A



## Basic Parameters

Size: $\phi 3.96\text{M} \times \text{H}2.92\text{M}$	Area: 11.5m <sup>2</sup>
Proposal Application: Camping / Restaurant	N.W.: 280Kg
Main Material: PC + Alu.	Service Life: >25 Years

## Basic Configurations

Main PC Dome: 1 Set	Alu. Alloy Base: 1 Set
Alu. Door with Mechanical Lock: 1 Set	Alu. Window: 2 Sets
Top Alu. Alloy Connecting Ring: 1 Set	Installation Kits: 1 Set

## Optional Configurations

* Curtain System - Manual or electric version optional	
* RGB LED Lighting	* Base LED Lighting
* Exhaust Fan	* Window Screen for the Door
* Window Screen for the Window	* Electronic Lock
* D2.1M Bathroom Dome	* Infrared Resistance PC Body

**Polycarbonate (PC):** Imported from Bayer, Germany. With double-sided 100 $\mu$  UV coating, 100% UV resistance.

**Aluminum Alloy Base:** 6063-T5 aluminum alloy with anodizing treatment as well as powder coating, it's anti-corrosion.

# Dreamdomes 4.5A



## Basic Parameters

Size: $\varnothing$ 4.50M*H3.2M	Area: 15.6m <sup>2</sup>
Proposal Application: Camping / Restaurant	N.W.: 350Kg
Main Material: PC + Alu.	Service Life: >25 Years

## Basic Configurations

Main PC Dome: 1 Set	Alu. Alloy Base: 1 Set
Alu. Door with Mechanical Lock: 1 Set	Alu. Window: 2 Sets
Top Alu. Alloy Connecting Ring: 1 Set	Installation Kits: 1 Set

## Optional Configurations

* Curtain System - Manual or electric version optional	
* RGB LED Lighting	* Base LED Lighting
* Exhaust Fan	* Window Screen for the Door
* Window Screen for the Window	* Electronic Lock
* D2.1M Bathroom Dome / Built-in Bathroom	* Infrared Resistance PC Body

**Polycarbonate (PC):** Imported from Bayer, Germany. With double-sided 100 $\mu$  UV coating, 100% UV resistance.

**Aluminum Alloy Base:** 6063-T5 aluminum alloy with anodizing treatment as well as powder coating, it's anti-corrosion.

## Dreamdomes 5.3A



### Basic Parameters

Size:  $\phi 5.37\text{M} \times \text{H}3.5\text{M}$

Area: 21.9m<sup>2</sup>

Proposal Application: Camping / Restaurant

N.W.: 475Kg

Main Material: PC + Alu.

Service Life: >25 Years

### Basic Configurations

Main PC Dome: 1 Set

Alu. Alloy Base: 1 Set

Alu. Door with Mechanical Lock: 1 Set

Alu. Window: 2 Sets

Top Alu. Alloy Connecting Ring: 1 Set

Installation Kits: 1 Set

### Optional Configurations

\* Curtain System - Manual or electric version optional

\* RGB LED Lighting

\* Base LED Lighting

\* Exhaust Fan

\* Window Screen for the Door

\* Window Screen for the Window

\* Electronic Lock

\* D2.1M Bathroom Dome / Built-in Bathroom

\* Infrared Resistance PC Body

**Polycarbonate (PC):** Imported from Bayer, Germany. With double-sided 100 $\mu$  UV coating, 100% UV resistance.

**Aluminum Alloy Base:** 6063-T5 aluminum alloy with anodizing treatment as well as powder coating, it's anti-corrosion.

# Dreamdomes 6.2A



## Basic Parameters

Size: $\phi 6.18M * H3.8M$	Area: 29.2m <sup>2</sup>
Proposal Application: Camping / Restaurant	N.W.: 600Kg
Main Material: PC + Alu.	Service Life: >25 Years

## Basic Configurations

Main PC Dome: 1 Set	Alu. Alloy Base: 1 Set
Alu. Door with Mechanical Lock: 1 Set	Alu. Window: 3 Sets
Top Alu. Alloy Connecting Ring: 1 Set	Installation Kits: 1 Set

## Optional Configurations

* Curtain System - Manual or electric version optional	
* RGB LED Lighting	* Base LED Lighting
* Exhaust Fan	* Window Screen for the Door
* Window Screen for the Window	* Electronic Lock
* D2.1M Bathroom Dome / Built-in Bathroom	* Infrared Resistance PC Body

**Polycarbonate (PC):** Imported from Bayer, Germany. With double-sided 100 $\mu$  UV coating, 100% UV resistance.

**Aluminum Alloy Base:** 6063-T5 aluminum alloy with anodizing treatment as well as powder coating, it's anti-corrosion.



# Dreamdomes 7.2A



## Basic Parameters

Size: $\phi 7.15M * H4.5M$	Area: 39.2m <sup>2</sup>
Proposal Application: Camping / Restaurant	N.W.: 780Kg
Main Material: PC + Alu.	Service Life: >25 Years

## Basic Configurations

Main PC Dome: 1 Set	Alu. Alloy Base: 1 Set
Alu. Door with Mechanical Lock: 1 Set	Alu. Window: 3 Sets
Top Alu. Alloy Connecting Ring: 1 Set	Installation Kits: 1 Set

## Optional Configurations

* Curtain System - Manual or electric version optional	
* RGB LED Lighting	* Base LED Lighting
* Exhaust Fan	* Window Screen for the Door
* Window Screen for the Window	* Electronic Lock
* D2.1M Bathroom Dome / Built-in Bathroom	* Infrared Resistance PC Body

**Polycarbonate (PC):** Imported from Bayer, Germany. With double-sided 100 $\mu$  UV coating, 100% UV resistance.

**Aluminum Alloy Base:** 6063-T5 aluminum alloy with anodizing treatment as well as powder coating, it's anti-corrosion.

# Dreamdomes 8.1A



## Basic Parameters

Size: $\phi 8.14M * H5.5M$	Area: 50m <sup>2</sup>
Proposal Application: Camping / Restaurant	N.W.: 880Kg
Main Material: PC + Alu.	Service Life: >25 Years

## Basic Configurations

Main PC Dome: 1 Set	Alu. Alloy Base: 1 Set
Alu. Door with Mechanical Lock: 1 Set	Alu. Window: 4 Sets
Top Alu. Alloy Connecting Ring: 1 Set	Installation Kits: 1 Set

## Optional Configurations

* Curtain System - Manual or electric version optional	
* RGB LED Lighting	* Base LED Lighting
* Exhaust Fan	* Window Screen for the Door
* Window Screen for the Window	* Electronic Lock
* D2.1M Bathroom Dome / Built-in Bathroom	* Infrared Resistance PC Body

**Polycarbonate (PC):** Imported from Bayer, Germany. With double-sided 100 $\mu$  UV coating, 100% UV resistance.

**Aluminum Alloy Base:** 6063-T5 aluminum alloy with anodizing treatment as well as powder coating, it's anti-corrosion.

# Dreamdomes 10.0A



## Basic Parameters

Size: $\phi 10M * H5.8M$	Area: $78.5m^2 / 150m^2$
Proposal Application: Camping / Restaurant	N.W.: 3000Kg
Main Material: PC + Alu.	Service Life: >25 Years

## Basic Configurations

Main PC Dome: 1 Set	Alu. Alloy Base: 1 Set
Alu. Door with Mechanical Lock: 1 Set	Alu. Window: 9 Sets ( 2 Floors)
Top Alu. Alloy Connecting Ring: 1 Set	Installation Kits: 1 Set

## Optional Configurations

* The Second Floor Platform	* Electric Curtain System
* RGB LED Lighting	* Base LED Lighting
* Exhaust Fan	* Window Screen for the Door
* Window Screen for the Window	* Electronic Lock
* D2.1M Bathroom Dome / Built-in Bathroom	* Infrared Resistance PC Body

**Polycarbonate (PC):** Imported from Bayer, Germany. With double-sided  $100\mu$  UV coating, 100% UV resistance.

**Aluminum Alloy Base:** 6063-T5 aluminum alloy with anodizing treatment as well as powder coating, it's anti-corrosion.

# Dreamdomes 4.0 + 2.1



## Basic Parameters

Size: $\phi 3.96\text{M} * \text{H}2.92\text{M} + \phi 2.1\text{M} * \text{H}2.57\text{M}$	Area: $11.5\text{m}^2 + 3.1\text{m}^2$
Proposal Application: Camping / Glamping	N.W.: 280 + 150Kg
Main Material: PC + Alu.	Service Life: >25 Years

## Basic Configurations

Main PC Dome: 2 Sets	Alu. Alloy Base: 2 Sets
Alu. Door with Mechanical Lock: 1 Set	Alu. Window: 2 Sets
Top Alu. Alloy Connecting Ring: 2 Sets	Installation Kits: 1 Set
Connecting Part with Alu. Door: 1 Set	

## Optional Configurations

* Curtain System - Manual or electric version optional	
* RGB LED Lighting	* Base LED Lighting
* Exhaust Fan	* Window Screen for the Door
* Window Screen for the Window	* Electronic Lock
* Infrared Resistance PC Body	

**Polycarbonate (PC):** Imported from Bayer, Germany. With double-sided  $100\mu$  UV coating, 100% UV resistance.

**Aluminum Alloy Base:** 6063-T5 aluminum alloy with anodizing treatment as well as powder coating, it's anti-corrosion.

# Dreamdomes 4.5 + 2.1



## Basic Parameters

Size:  $\phi 5.37M * H3.5M + \phi 2.1M * H2.57M$  Area:  $15,6m^2 + 3.1m^2$

Proposal Application: Camping / Glamping N.W.: 350 + 150Kg

Main Material: PC + Alu. Service Life: >25 Years

## Basic Configurations

Main PC Dome: 2 Sets Alu. Alloy Base: 2 Sets

Alu. Door with Mechanical Lock: 1 Set Alu. Window: 2 Sets

Top Alu. Alloy Connecting Ring: 2 Sets Installation Kits: 1 Set

Connecting Part with Alu. Door: 1 Set

## Optional Configurations

\* Curtain System - Manual or electric version optional

\* RGB LED Lighting

\* Base LED Lighting

\* Exhaust Fan

\* Window Screen for the Door

\* Window Screen for the Window

\* Electronic Lock

\* Infrared Resistance PC Body

**Polycarbonate (PC):** Imported from Bayer, Germany. With double-sided  $100\mu$  UV coating, 100% UV resistance.

**Aluminum Alloy Base:** 6063-T5 aluminum alloy with anodizing treatment as well as powder coating, it's anti-corrosion.

# Dreamdomes 5.3 + 2.1



## Basic Parameters

Size: $\varphi 4.50\text{M} * \text{H}3.2\text{M} + \varphi 2.1\text{M} * \text{H}2.57\text{M}$	Area: $21,9\text{m}^2 + 3.1\text{m}^2$
Proposal Application: Camping / Glamping	N.W.: 475 + 150Kg
Main Material: PC + Alu.	Service Life: >25 Years

## Basic Configurations

Main PC Dome: 2 Sets	Alu. Alloy Base: 2 Sets
Alu. Door with Mechanical Lock: 1 Set	Alu. Window: 2 Sets
Top Alu. Alloy Connecting Ring: 2 Sets	Installation Kits: 1 Set
Connecting Part with Alu. Door: 1 Set	

## Optional Configurations

* Curtain System - Manual or electric version optional	
* RGB LED Lighting	* Base LED Lighting
* Exhaust Fan	* Window Screen for the Door
* Window Screen for the Window	* Electronic Lock
* Infrared Resistance PC Body	

**Polycarbonate (PC):** Imported from Bayer, Germany. With double-sided  $100\mu$  UV coating, 100% UV resistance.

**Aluminum Alloy Base:** 6063-T5 aluminum alloy with anodizing treatment as well as powder coating, it's anti-corrosion.

# Dreamdomes 4.5 + 3.5 + 2.1



## Basic Parameters

Size: $\varphi 4.50 * H 3.2M + \varphi 3.48 * H 2.7M + \varphi 2.1 * H 2.57M$	Area: 15.6 + 9.2 + 3.1 m <sup>2</sup>
Proposal Application: Camping / Glamping	N.W.: 350 + 220 + 150Kg
Main Material: PC + Alu.	Service Life: >25 Years

## Basic Configurations

Main PC Dome: 3 Sets	Alu. Alloy Base: 3 Sets
Alu. Door with Mechanical Lock: 1 Set	Alu. Window: 4 Sets
Top Alu. Alloy Connecting Ring: 3 Sets	Installation Kits: 1 Set
Connecting Part with Alu. Door: 2 Sets	

## Optional Configurations

* Curtain System - Manual or electric version optional	
* RGB LED Lighting	* Base LED Lighting
* Exhaust Fan	* Window Screen for the Door
* Window Screen for the Window	* Electronic Lock
* Infrared Resistance PC Body	

**Polycarbonate (PC):** Imported from Bayer, Germany. With double-sided 100μ UV coating, 100% UV resistance.

**Aluminum Alloy Base:** 6063-T5 aluminum alloy with anodizing treatment as well as powder coating, it's anti-corrosion.

# Dreamdomes 5.3 + 4.5 + 2.1



## Basic Parameters

Size: $\phi 5.37 * H 3.5M + \phi 4.50 * H 3.2M + \phi 2.1 * H 2.57M$	Area: 21.9 + 15.6 + 3.1m <sup>2</sup>
Proposal Application: Camping / Glamping	N.W.: 475 + 350 + 150Kg
Main Material: PC + Alu.	Service Life: >25 Years

## Basic Configurations

Main PC Dome: 3 Sets	Alu. Alloy Base: 3 Sets
Alu. Door with Mechanical Lock: 1 Set	Alu. Window: 4 Sets
Top Alu. Alloy Connecting Ring: 3 Sets	Installation Kits: 1 Set
Connecting Part with Alu. Door: 2 Sets	

## Optional Configurations

* Curtain System - Manual or electric version optional	
* RGB LED Lighting	* Base LED Lighting
* Exhaust Fan	* Window Screen for the Door
* Window Screen for the Window	* Electronic Lock
* Infrared Resistance PC Body	

**Polycarbonate (PC):** Imported from Bayer, Germany. With double-sided 100μ UV coating, 100% UV resistance.

**Aluminum Alloy Base:** 6063-T5 aluminum alloy with anodizing treatment as well as powder coating, it's anti-corrosion.



# Dreamdomes 4.5 + 4.5 + 2.1



## Basic Parameters

Size: $\phi 4.5 * H 3.2 M + \phi 4.5 * H 3.2 M + \phi 2.1 * H 2.57 M$	Area: 15.6 + 15.6 + 3.1 m <sup>2</sup>
Proposal Application: Camping / Glamping	N.W.: 350 + 350 + 150 Kg
Main Material: PC + Alu.	Service Life: >25 Years

## Basic Configurations

Main PC Dome: 3 Sets	Alu. Alloy Base: 3 Sets
Alu. Door with Mechanical Lock: 1 Set	Alu. Window: 4 Sets
Top Alu. Alloy Connecting Ring: 3 Sets	Installation Kits: 1 Set
Connecting Part with Alu. Door: 2 Sets	

## Optional Configurations

* Curtain System - Manual or electric version optional	
* RGB LED Lighting	* Base LED Lighting
* Exhaust Fan	* Window Screen for the Door
* Window Screen for the Window	* Electronic Lock
* Infrared Resistance PC Body	

**Polycarbonate (PC):** Imported from Bayer, Germany. With double-sided 100 $\mu$  UV coating, 100% UV resistance.

**Aluminum Alloy Base:** 6063-T5 aluminum alloy with anodizing treatment as well as powder coating, it's anti-corrosion.

# Starry Sky Pro Series Polycarbonate Domes

The first double-layer hollow insulated polycarbonate dome on the market!

**New**



# Dreamdomes 6.2Pro



## Basic Parameters

Size: $\phi 6.2.0M * H3.68M$	Area: 28m <sup>2</sup>
Proposal Application: Camping / Restaurant	N.W.: 750Kg
Main Material: PC + Alu.	Service Life: >25 Years

## Basic Configurations

Main Double-layer PC Dome: 1 Set	Alu. Alloy Base: 1 Set
Alu. Door with Mechanical Lock: 1 Set	Alu. Window: 2 Sets
Top Alu. Alloy Connecting Ring: 1 Set	Waterproof Arched Porch: 1 Set

## Optional Configurations

* Curtain System - Manual or electric version optional	
* RGB LED Lighting	* Base LED Lighting
* Exhaust Fan	* Window Screen for the Door
* Window Screen for the Window	* Electronic Lock
* Built-in Bathroom with Bunk Bed	* Opaque PC

**Polycarbonate (PC):** Imported from Bayer, Germany. With double-sided 100 $\mu$  UV coating, 100% UV resistance.

**Aluminum Alloy Base:** 6063-T5 aluminum alloy with anodizing treatment as well as powder coating, it's anti-corrosion.

# Star Capsule Series Polycarbonate Domes



# Dreamdomes B3550



## Basic Parameters

Size: L5000 \* W3500 \* H 2700mm

Area: 15m<sup>2</sup>

Propasal Application: Restaurants / Cooffe Shop

Main Material: PC + Alu.

Platform size: L6500\*W4500mm

Service Life: >25 Years

## Basic Configurations

Main PC Dome: 1 Set

Alu. Alloy Base: 1 Set

Alu. Door with Mechanical Lock: 1 Set

Alu. Window: 2 Sets

Top Alu. Alloy Connecting Ring: 1 Set

Installation Kits: 1 Set

## Optional Configurations

\* Manual Curtain System

\* RGB LED Lighting

\* Base LED Lighting

\* Exhaust Fan

\* Window Screen for the Door

\* Window Screen for the Window

\* Electronic Lock

**Polycarbonate (PC):** Imported from Bayer, Germany. With double-sided 100μ UV coating, 100% UV resistance.

**Aluminum Alloy Base:** 6063-T5 aluminum alloy with anodizing treatment as well as powder coating, it's anti-corrision.

# Dreamdomes B3565



## Basic Parameters

Size: L6500 * W3500 * H 2700mm	Area: 20m <sup>2</sup>
Propasal Application: Restaurants / Glamping	Main Material: PC + Alu.
Platform size: L7500*W4500mm	Service Life: >25 Years

## Basic Configurations

Main PC Dome: 1 Set	Alu. Alloy Base: 1 Set
Alu. Door with Mechanical Lock: 1 Set	Alu. Window: 2 Sets
Top Alu. Alloy Connecting Ring: 1 Set	Installation Kits: 1 Set

## Optional Configurations

* Manual Curtain System	* RGB LED Lighting
* Base LED Lighting	* Exhaust Fan
* Window Screen for the Door	* Window Screen for the Window
* Electronic Lock	

**Polycarbonate (PC):** Imported from Bayer, Germany. With double-sided 100μ UV coating, 100% UV resistance.

**Aluminum Alloy Base:** 6063-T5 aluminum alloy with anodizing treatment as well as powder coating, it's anti-corrision.

# Dreamdomes B3580



## Basic Parameters

Size: L8000 * W3500 * H 2700mm	Area: 25m <sup>2</sup>
Propasal Application: Restaurants / Cooffe Shop	Main Material: PC + Alu.
Platform size: L9000*W4500mm	Service Life: >25 Years

## Basic Configurations

Main PC Dome: 1 Set	Alu. Alloy Base: 1 Set
Alu. Door with Mechanical Lock: 1 Set	Alu. Window: 3 Sets
Top Alu. Alloy Connecting Ring: 1 Set	Installation Kits: 1 Set

## Optional Configurations

* Manual Curtain System	* RGB LED Lighting
* Base LED Lighting	* Exhaust Fan
* Window Screen for the Door	* Window Screen for the Window
* Electronic Lock	

**Polycarbonate (PC):** Imported from Bayer, Germany. With double-sided 100μ UV coating, 100% UV resistance.

**Aluminum Alloy Base:** 6063-T5 aluminum alloy with anodizing treatment as well as powder coating, it's anti-corrision.

# Dreamdomes B1828



## Basic Parameters

Size: L2800 * W1800 * H 2200mm	Area: 5.0m <sup>2</sup>
Proposal Application: Camping	Platform size: L3500*W2500mm
Main Material: PC + Alu.	Service Life: >25 Years

## Basic Configurations

Main PC Dome: 1 Set	Alu. Alloy Base: 1 Set
Alu. Door with Electronic Lock: 1 Set	Alu. Window: 2 Sets
Top Alu. Alloy Connecting Ring: 1 Set	Installation Kits: 1 Set
Manual Curtain System: 1 Set	RGB LED Lighting: 1 Set
Screen Window for the Door: 1 Set	Top Sliding Window: 1 Set
Screen Window for the Window: 2 Sets	Top LED Downlight: 1 Piece
Exhaust Fan: 1 Set	Mattress: 1 Set
Installation Kits: 1 Set	

**Polycarbonate (PC):** Imported from Bayer, Germany. With double-sided 100μ UV coating, 100% UV resistance.

**Aluminum Alloy Base:** 6063-T5 aluminum alloy with anodizing treatment as well as powder coating, it's anti-corrosion.



# Dreamdomes B4071



## Basic Parameters

Size: L7100 * W4000 * H 2900mm	Area: 25m <sup>2</sup>
Proposal Application: Glamping	Main Material: PC + Alu.
Platform size: L8500*W5000mm	Service Life: >25 Years

## Basic Configurations

Infrared Resistance PC Dome: 1 Set	Alu. Alloy Base: 1 Set
Alu. Door with Mechanical Lock: 1 Set	Alu. Window: 3 Sets
Top Alu. Alloy Connecting Ring: 1 Set	Installation Kits: 1 Set

## Optional Configurations

* Manual Curtain System	* RGB LED Lighting
* Base LED Lighting	* Exhaust Fan
* Window Screen for the Door	* Window Screen for the Window
* Electronic Lock	

**Polycarbonate (PC):** Imported from Bayer, Germany. With double-sided 100μ UV coating, 100% UV resistance.

**Aluminum Alloy Base:** 6063-T5 aluminum alloy with anodizing treatment as well as powder coating, it's anti-corrosion.

# Dreamdomes B4576



## Basic Parameters

Size: L7600 \* W4500 \* H 3200mm

Area: 30m<sup>2</sup>

Propasal Application: Glamping

Main Material: PC + Alu.

Platform size: L9000\*W5500mm

Service Life: >25 Years

## Basic Configurations

Infrared Resistance PC Dome: 1 Set

Alu. Alloy Base: 1 Set

Alu. Door with Mechanical Lock: 1 Set

Alu. Window: 3 Sets

Top Alu. Alloy Connecting Ring: 1 Set

Installation Kits: 1 Set

## Optional Configurations

\* Manual Curtain System

\* RGB LED Lighting

\* Base LED Lighting

\* Exhaust Fan

\* Window Screen for the Door

\* Window Screen for the Window

\* Electronic Lock

**Polycarbonate (PC):** Imported from Bayer, Germany. With double-sided 100μ UV coating, 100% UV resistance.

**Aluminum Alloy Base:** 6063-T5 aluminum alloy with anodizing treatment as well as powder coating, it's anti-corrosion.

# Dreamdomes B4585



## Basic Parameters

Size: L8500 * W4500 * H 3200mm	Area: 35m <sup>2</sup>
Propasal Application: Glamping	Main Material: PC + Alu.
Platform size: L9500*W5500mm	Service Life: >25 Years

## Basic Configurations

Infrared Resistance PC Dome: 1 Set	Alu. Alloy Base: 1 Set
Alu. Door with Mechanical Lock: 1 Set	Alu. Window: 4 Sets
Top Alu. Alloy Connecting Ring: 1 Set	Installation Kits: 1 Set

## Optional Configurations

* Manual Curtain System	* RGB LED Lighting
* Base LED Lighting	* Exhaust Fan
* Window Screen for the Door	* Window Screen for the Window
* Electronic Lock	

**Polycarbonate (PC):** Imported from Bayer, Germany. With double-sided 100μ UV coating, 100% UV resistance.

**Aluminum Alloy Base:** 6063-T5 aluminum alloy with anodizing treatment as well as powder coating, it's anti-corrision.

# Stargate Series Polycarbonate Domes



# Dreamdomes D3.5



## Basic Parameters

Size: $\phi 3.5 \times H 2.7M$	Area: $9.6m^2$
Proposal Application: Restaurant / Coffee Shop	Main Material: PC + Alu.
Platform size: $\phi 4.5M$	Service Life: >25 Years
Type of Door: Sliding Door	
Color of Alu. Frame: Black	

## Basic Configurations

100% UV Resistance Polycarbonate Dome: 1 Set
6063-T5 Aluminum Alloy Frame: 1 Set
6063-T5 Aluminum Alloy Base: 1 Set
Sliding Door: 1 Set
High Efficiency Exhaust Fan: 1 Set
SMD5050 RGB LED Lighting: 1 Set
SMD2835 Warm White Base LED Lighting: 1 Set

**Polycarbonate (PC):** Imported from Bayer, Germany. With double-sided  $100\mu$  UV coating, 100% UV resistance.

**Aluminum Alloy Base:** 6063-T5 aluminum alloy with anodizing treatment as well as powder coating, it's anti-corrosion.

# Dreamdomes D4.0



## Basic Parameters

Size: $\phi 4.0 * H 2.9 M$	Area: 12.5m <sup>2</sup>
Propasal Application: Restaurant / Cooffee Shop	Main Material: PC + Alu.
Platform size: $\phi 5.0 M$	Service Life: >25 Years
Type of Door: Sliding Door	
Color of Alu. Frame: Black	

## Basic Configurations

100% UV Resistance Polycarbonate Dome: 1 Set
6063-T5 Aluminum Alloy Frame: 1 Set
6063-T5 Aluminum Alloy Base: 1 Set
Sliding Door: 1 Set
High Efficiency Exhaust Fan: 1 Set
SMD5050 RGB LED Lighting: 1 Set
SMD2835 Warm White Base LED Lighting: 1 Set

**Polycarbonate (PC):** Imported from Bayer, Germany. With double-sided 100 $\mu$  UV coating, 100% UV resistance.

**Aluminum Alloy Base:** 6063-T5 aluminum alloy with anodizing treatment as well as powder coating, it's anti-corrision.

# Dreamdomes D4.5



## Basic Parameters

Size: $\phi 4.5 * H3.2M$	Area: 15.9m <sup>2</sup>
Propasal Application: Restaurant / Cooffee Shop	Main Material: PC + Alu.
Platform size: $\phi 5.5M$	Service Life: >25 Years
Type of Door: Sliding Door	
Color of Alu. Frame: Black	

## Basic Configurations

100% UV Resistance Polycarbonate Dome: 1 Set
6063-T5 Aluminum Alloy Frame: 1 Set
6063-T5 Aluminum Alloy Base: 1 Set
Sliding Door: 1 Set
High Efficiency Exhaust Fan: 1 Set
SMD5050 RGB LED Lighting: 1 Set
SMD2835 Warm White Base LED Lighting: 1 Set

**Polycarbonate (PC):** Imported from Bayer, Germany. With double-sided 100 $\mu$  UV coating, 100% UV resistance.

**Aluminum Alloy Base:** 6063-T5 aluminum alloy with anodizing treatment as well as powder coating, it's anti-corrision.

# Stargate-L Series Polycarbonate Domes

New





# Dreamdomes L18



**\* Size can be customized!**

## Basic Parameters

Size: L18000*W6000*H3500mm	Area: 100m <sup>2</sup>
Proposal Application: Restaurant / Cooffee Shop	Main Material: PC + Alu.
Platform size: L20000*W7500mm	Service Life: >25 Years
Type of Door: Sliding Door	
Color of Alu. Frame: Black	

## Basic Configurations

100% UV Resistance Polycarbonate Dome: 1 Set
6063-T5 Aluminum Alloy Frame: 1 Set
6063-T5 Aluminum Alloy Base: 1 Set
Sliding Door: 1 Set
High Efficiency Exhaust Fan: 1 Set
SMD5050 RGB LED Lighting: 1 Set
SMD2835 Warm White Base LED Lighting: 1 Set

**Polycarbonate (PC):** Imported from Bayer, Germany. With double-sided 100μ UV coating, 100% UV resistance.

**Aluminum Alloy Base:** 6063-T5 aluminum alloy with anodizing treatment as well as powder coating, it's anti-corrision.

# DreamKajak Series Polycarbonate Kayak



# DreamKajak K02

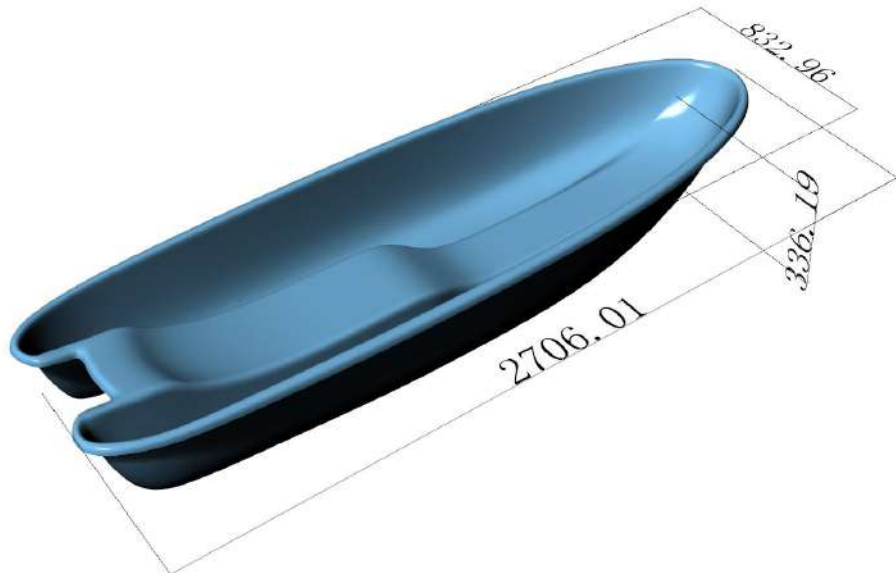

## Basic Parameters

Size: L2706 * W833 * H336mm	Thickness of PC: 6mm
Capacity : 1 Person	Max Loading: 120Kg
N.W. Weight: 24Kg	Warranty: 1 Year

## Basic Configurations

- \* Imported Bayer Polycarbonate Hull: 1 Set
- \* Airbag: 1 Piece
- \* Clear Bayer Polycarbonate Seat: 1 Set
- \* Paddles: 1 Set
- \* Side Airbag Balancing Device: 1 Set - 2 Pieces
- \* Black Aluminium Alloy Edge: 1 Set
- \* Clear Kayak Skeg: 1 Set

**Polycarbonate (PC):** Imported from Bayer, Germany. It's durable and lightweight.

**Aluminum Alloy Base:** 6063-T5 aluminum alloy with anodizing treatment as well as powder coating, it's anti-corrosion.

# DreamKajak K03-T

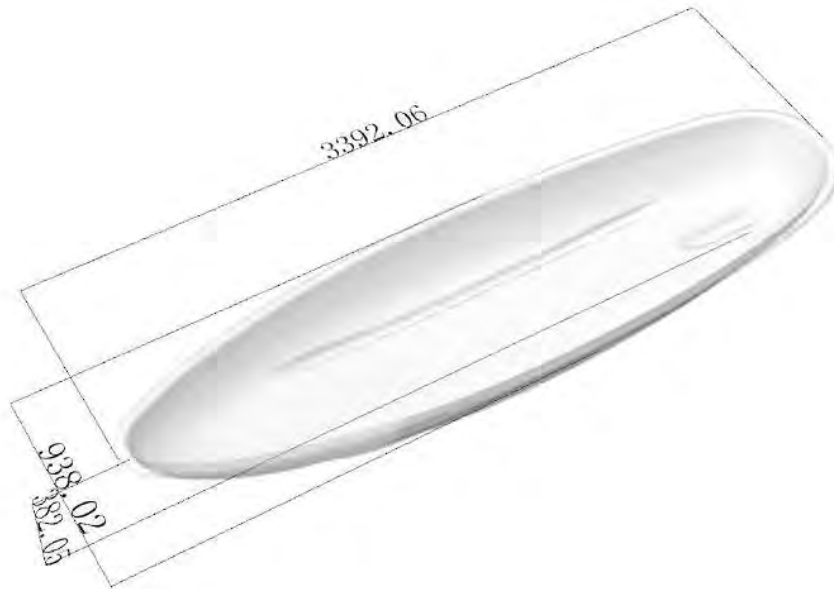

## Basic Parameters

Size: L3392 \* W938 \* H382mm

Thickness of PC: 6mm

Capacity : 2 People

Max Loading: 220Kg

N.W. Weight: 31Kg

Warranty: 1 Year

## Basic Configurations

\* Imported Bayer Polycarbonate Hull: 1 Set

\* Airbag: 2 Pieces

\* Clear Bayer Polycarbonate Seat: 2 Sets

\* Paddles: 2 Sets

\* Side Airbag Balancing Device: 1 Set - 2 Pieces

\* Black Aluminium Alloy Edge: 1 Set

\* Clear Kayak Skeg: 1 Set

**Polycarbonate (PC):** Imported from Bayer, Germany. It's durable and lightweight.

**Aluminum Alloy Base:** 6063-T5 aluminum alloy with anodizing treatment as well as powder coating, it's anti-corrosion.

# DreamKajak K03-B

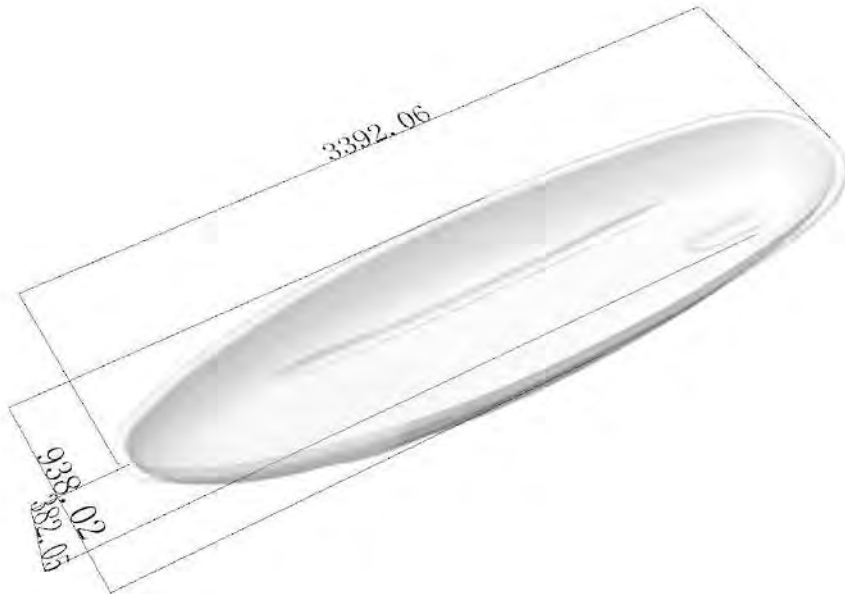

## Basic Parameters

Size: L3392 \* W938 \* H382mm

Thickness of PC: 6mm

Capacity : 2 People

Max Loading: 210Kg

N.W. Weight: 32Kg

Warranty: 1 Year

## Basic Configurations

\* Imported Bayer Polycarbonate Hull: 1 Set

\* Airbag: 2 Pieces

\* Clear Bayer Polycarbonate Seat: 2 Sets

\* Paddles: 2 Sets

\* Balance Bar with Floats: 1 Set

\* Black Aluminium Alloy Edge: 1 Set

\* Clear Kayak Skeg: 1 Set

**Polycarbonate (PC):** Imported from Bayer, Germany. It's durable and lightweight.

**Aluminum Alloy Base:** 6063-T5 aluminum alloy with anodizing treatment as well as powder coating, it's anti-corrosion.

# DreamBoard Series Clear SUP Board



# DreamBoard SUP01

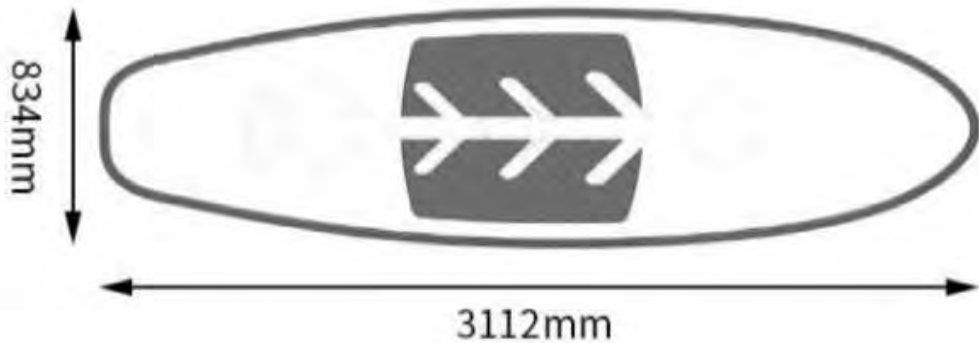

## Basic Parameters

Size: L3122 * W834 * H210mm	Thickness of PC: 6mm
Capacity : 1-2 People	Max Loading: 220Kg
N.W. Weight: 23Kg	Warranty: 1 Year

## Basic Configurations

- \* Imported Bayer Polycarbonate SUP Board: 1 Set
- \* Paddle: 1 Set - 163-215cm (Alu. Alloy with high-strength plastic)
- \* Anti-Slip Pad: 1 Set ( Black / White)
- \* Foot Soiral Leash: 1 Set
- \* Rudder: 1 Set
- \* Logo: Customized

**Polycarbonate (PC):** Imported from Bayer, Germany. It's durable and lightweight.

**Rubber Ring:** The all-round solid rubber protection ensures on increased longevity of the SUP Board.

# DreamBoard SUP02

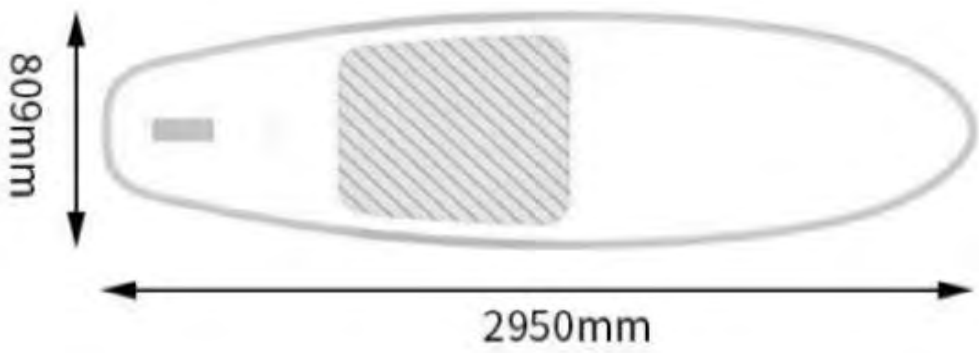

## Basic Parameters

Size: L2950 * W809 * H195mm	Thickness of PC: 6mm
Capacity : 1-2 People	Max Loading: 200Kg
N.W. Weight: 21Kg	Warranty: 1 Year

## Basic Configurations

- \* Imported Bayer Polycarbonate SUP Board: 1 Set
- \* Paddle: 1 Set - 163-215cm (Alu. Alloy with high-strength plastic)
- \* Anti-Slip Pad: 1 Set ( Black / White)
- \* Foot Soiral Leash: 1 Set
- \* Rudder: 1 Set
- \* Logo: Customized

**Polycarbonate (PC):** Imported from Bayer, Germany. It's durable and lightweight.

**Rubber Ring:** The all-round solid rubber protection ensures on increased longevity of the SUP Board.



# DreamBoard SUP03

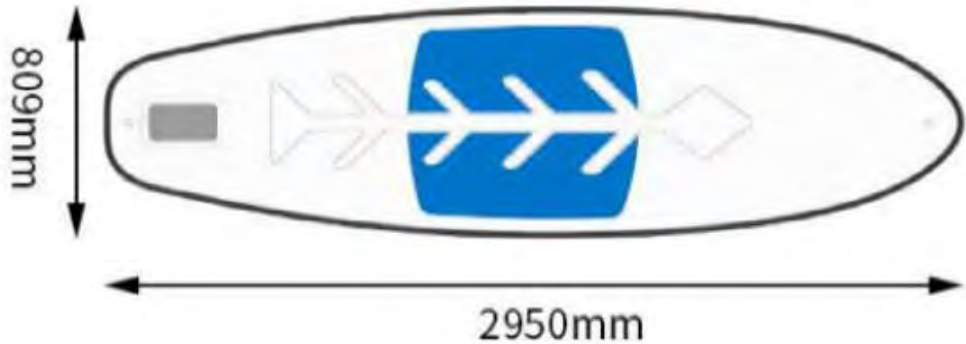

## Basic Parameters

Size: L2950 * W809 * H195mm	Thickness of PC: 6mm
Capacity : 1-2 People	Max Loading: 200Kg
N.W. Weight: 21Kg	Warranty: 1 Year

## Basic Configurations

- \* Imported Bayer Polycarbonate SUP Board: 1 Set
- \* Paddle: 1 Set - 163-215cm (Alu. Alloy with high-strength plastic)
- \* Anti-Slip Pad: 1 Set ( Black / White)
- \* Foot Soiral Leash: 1 Set
- \* Rudder: 1 Set
- \* Logo: Customized

**Polycarbonate (PC):** Imported from Bayer, Germany. It's durable and lightweight.

**Rubber Ring:** The all-round solid rubber protection ensures on increased longevity of the SUP Board.

# Product Applications +++



# Product Applications +++



# Customized Products and Projects +++





**Distributed by Dream Domes U.S.**



**Aurora Smart Technologies, LLC**

W. Gerard Poole, Ph.D.  
CEO/Founder

Diana Alger-Poole

202-531-0870  
info@Dreamdomes.US